

MOTOR PARAMETERS	ENGLISH UNITS	METRIC UNITS
CONTINUOUS TORQUE	42.22 in lb	4.77 N m
CONTINUOUS CURRENT	9.4 A _{RMS} / 13.29 A _{PK-PK}	
PEAK TORQUE	128.34 in lb	14.50 N m
PEAK CURRENT	28.30 A _{RMS} / 40.02 A _{PK-PK}	
RATED SPEED	3000 RPM / 315 rad/s	
MAX. OPERATING SPEED	5000 RPM / 525 rad/s	
RATED POWER	2.01 HP / 1500 W	
BACK EMF CONSTANT (K _c)	39.25 V/kRPM	
TORQUE CONSTANT (K _t)	4.69 in lb / A _{PK}	0.37 N m / A _{PK}
PHASE INDUCTANCE @25°C	3.840 mH	
PHASE RESISTANCE @25°C	0.366 ohms	
INERTIA (WITHOUT BRAKE)	8.17x10 ⁻¹ lb in ²	2.39 kg cm ²
INERTIA (WITH BRAKE)	9.70x10 ⁻¹ lb in ²	2.84 kg cm ²
NUMBER OF POLES	8	

POWER CONNECTOR BRAKE MOTOR RECEPTACLE: MS3102A 20-18P	
PIN	SIGNAL
A	/
B	W
C	/
D	FG
E	FG
F	U
G	BR
H	BR
I	V

MATING CONNECTOR CAP: MS3106A 20-18S	
---	--

POWER CONNECTOR NON-BRAKE RECEPTACLE: MS3102A 20-4P	
PIN	SIGNAL
A	U
B	V
C	W
D	FG

MATING CONNECTOR CAP: MS3106A 20-4S	
--	--

BRAKE INFORMATION		MOTOR FLANGE SIZE
ITEM	UNIT	100 mm
STATIC FRICTION TORQUE	N m	12
ROTOR INERTIA	kg cm ²	0.45
ARMATURE SUCTION TIME	ms	100
ARMATURE RELEASE TIME	ms	20
RELEASE VOLTAGE	DC, V	2 (AT 20°C)
EXCITATION VOLTAGE	DC, V	24 ± 2.4
EXCITATION CURRENT	DC, A	0.83

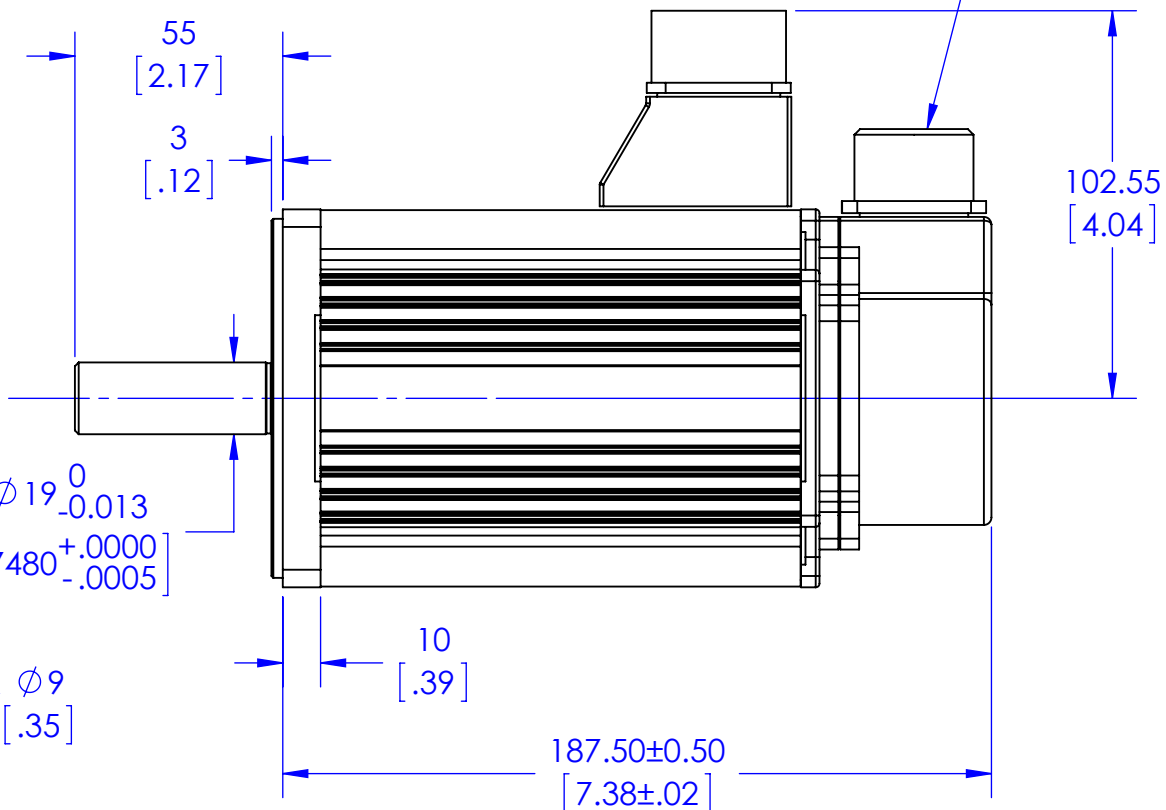
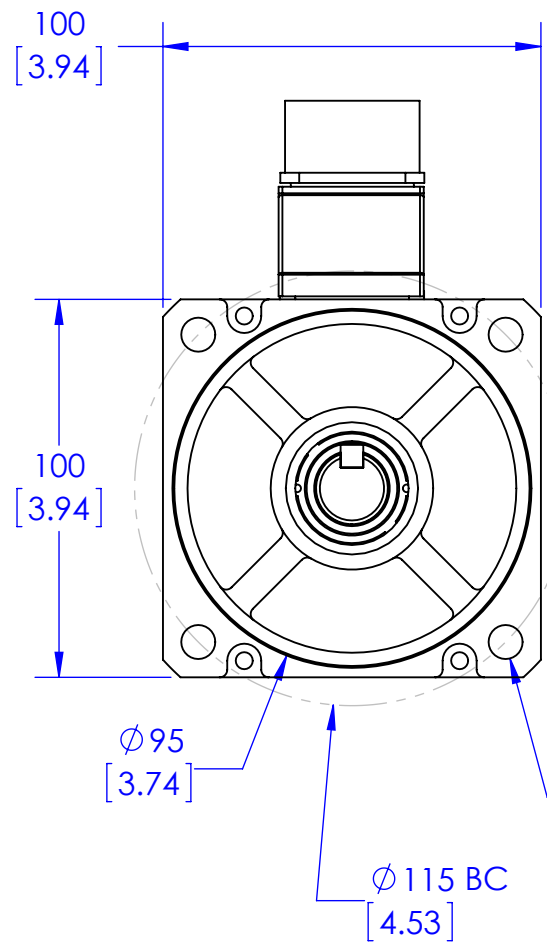

REFER TO FEEDBACK DEVICE DRAWING FOR MATING CONNECTOR AND PIN OUT INFORMATION

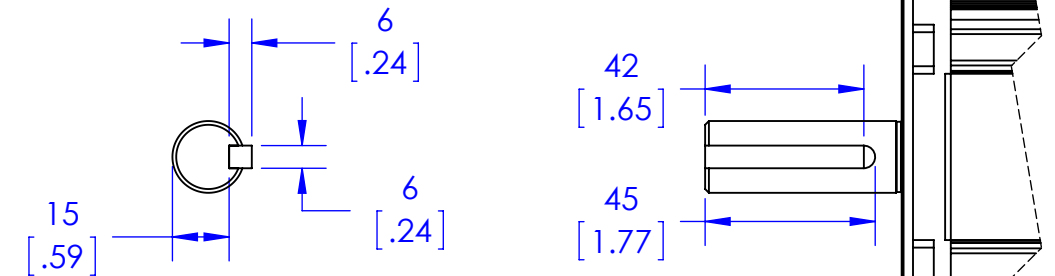

WITH BRAKE:
DIMENSIONS COMMON EXCEPT
WHERE INDICATED

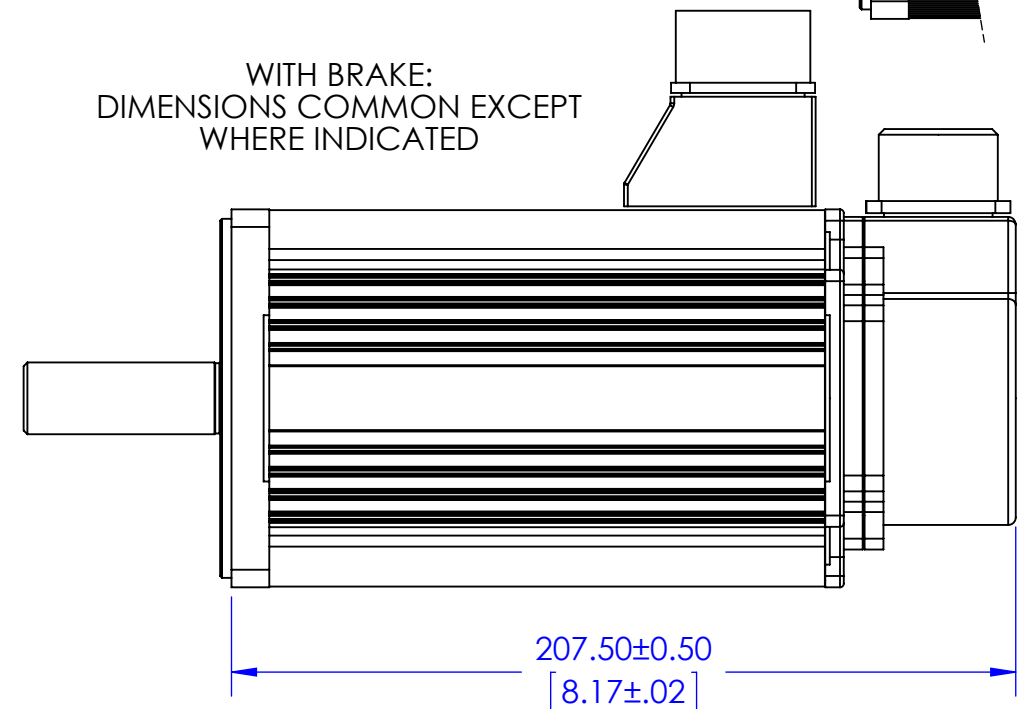

 23011 MOULTON PARKWAY, SUITE J3 LAGUNA HILLS, CA 92653	TITLE: QS100-B15-xB2 QS100-B15-xN2	
	SIZE B	DWG. NO. 100-1500-01
	SCALE: NONE	REV A SHEET 1 OF 1